

EITA-Schneider

10°-12° TRAVELATOR (ESITRAV-P) TECHNICAL SPECIFICATION

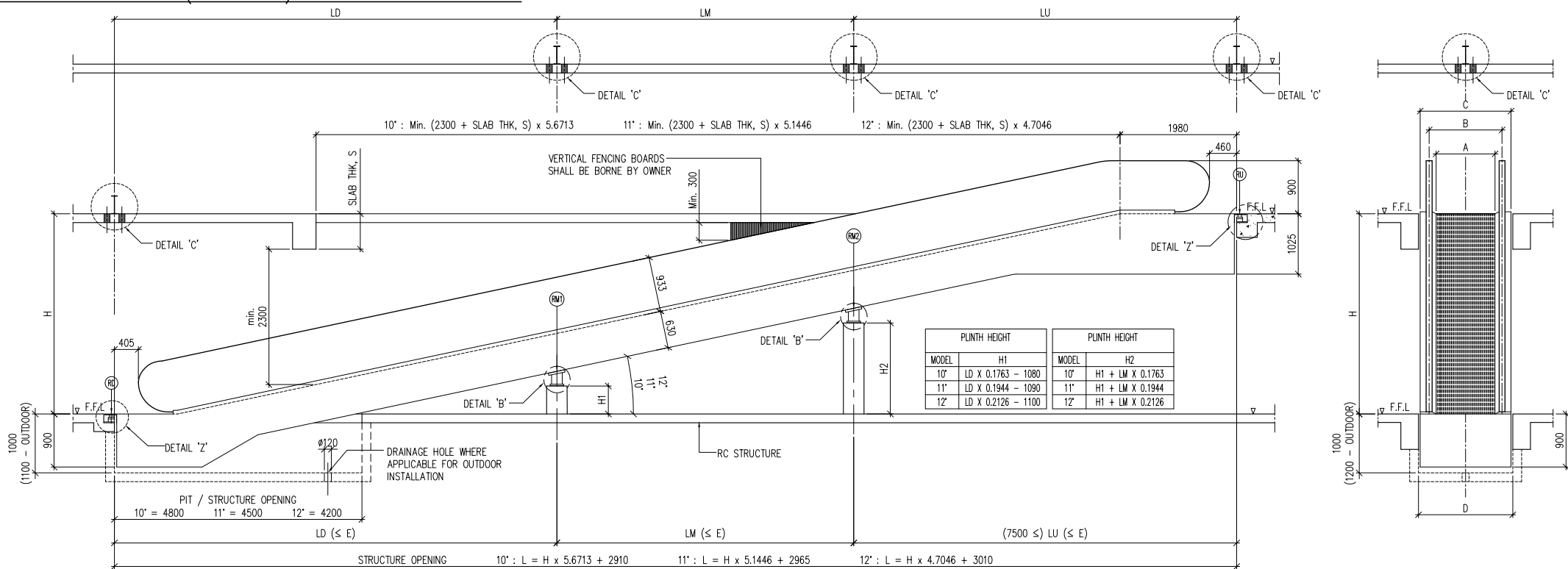

MODEL (10')	TRAVELLING HEIGHT (mm)	STRUCTURE OPENING (L)	XPL-10'-800 (4800 PEOPLE/HOUR)				XPL-10'-1000 (6000 PEOPLE/HOUR)				DIMENSION				
			SUPPORTING LOAD (kN)		MOTOR POWER (kW)		SUPPORTING LOAD (kN)		MOTOR POWER (kW)						
			RU	RD	RM1	RM2	RU	RD	RM1	RM2	LD	LU	LM		
3000	19924	44	36	90	7.5	51	43	107	7.5	9962	9962				
3500	22759	49	41	103	7.5	57	49	122	7.5	11379	11380				
4000	25595	54	46	116	7.5	64	55	138	11	12797	12798				
4500	28431	60	51	129	8	70	61	153	11	14216	14215				
5000	31266	66	57	141	11	54	45	99	99	10422	10422	10422			
5500	34102	50	41	91	91	11	58	49	108	108	11367	11367	11368		
6000	36938	54	45	98	98	11	62	53	116	116	12312	12313	12313		

MODEL (11')	TRAVELLING HEIGHT (mm)	STRUCTURE OPENING (L)	XPL-11'-800 (4800 PEOPLE/HOUR)				XPL-11'-1000 (6000 PEOPLE/HOUR)				DIMENSION				
			SUPPORTING LOAD (kN)		MOTOR POWER (kW)		SUPPORTING LOAD (kN)		MOTOR POWER (kW)						
			RU	RD	RM1	RM2	RU	RD	RM1	RM2	LD	LU	LM		
3000	18399	42	34	83	7.5	48	40	99	7.5	9700	9699				
3500	20971	45	38	95	7.5	53	45	113	7.5	10485	10486				
4000	23543	51	43	107	7.5	60	51	127	11	11771	11772				
4500	26155	55	47	119	7.5	65	56	141	11	13077	13078				
5000	28688	61	52	130	8	71	62	154	11	14344	14344				
5500	31260	63	57	141	11	54	45	99	99	110420	10420	10420			
6000	33832	50	41	90	90	11	58	49	107	107	11277	11277	11278		

MODEL (12')	TRAVELLING HEIGHT (mm)	STRUCTURE OPENING (L)	XPL-12'-800 (4800 PEOPLE/HOUR)				XPL-12'-1000 (6000 PEOPLE/HOUR)				DIMENSION			
			SUPPORTING LOAD (kN)		MOTOR POWER (kW)		SUPPORTING LOAD (kN)		MOTOR POWER (kW)					
			RU	RD	RM1	RM2	RU	RD	RM1	RM2	LD	LU	LM	
3000	17124	39	31	77	7.5	45	37	92	7.5	8562	8562			
3500	19476	43	35	88	7.5	50	42	105	7.5	9738	9738			
4000	21828	48	40	94	7.5	56	47	117	11	10914	10914			
4500	24181	52	44	110	7.5	61	52	130	11	12090	12090			
5000	26533	57	48	120	8	66	57	143	11	13266	13266			
5500	28885	61	52	130	11	71	62	155	11	14442	14443			
6000	31238	66	57	141	11	54	45	99	99	150412	10413	10413		

	XPL-800 (4800 PEOPLE/HOUR)	XPL-1000 (6000 PEOPLE/HOUR)
A	800	1000
B	1038	1238
C	1340	1540
D	1400	1600
E	16300	15000

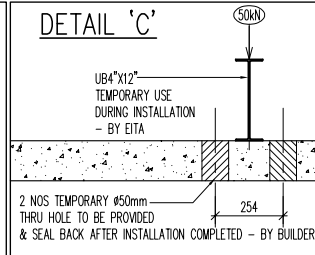
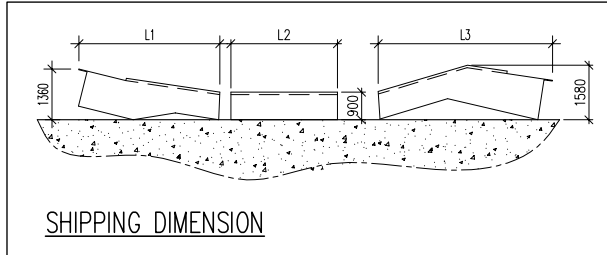
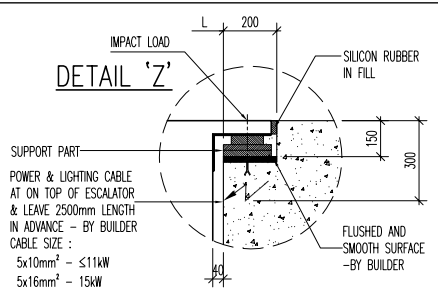
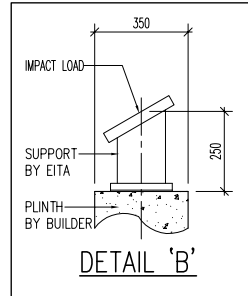

INCLINATION TYPE MOVING WALK CONSTRUCTION LAYOUT

NOTE: E DENOTES THE MAXIMUM DISTANCE BETWEEN TWO SUPPORTING POINTS